

1. Mercury
2. Andromeda
3. Perseus
4. The Putti
5. The Iron Baskets
6. The Melbourne Bicentenary Urn

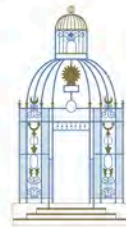

THE GARDENS  
MELBOURNE HALL

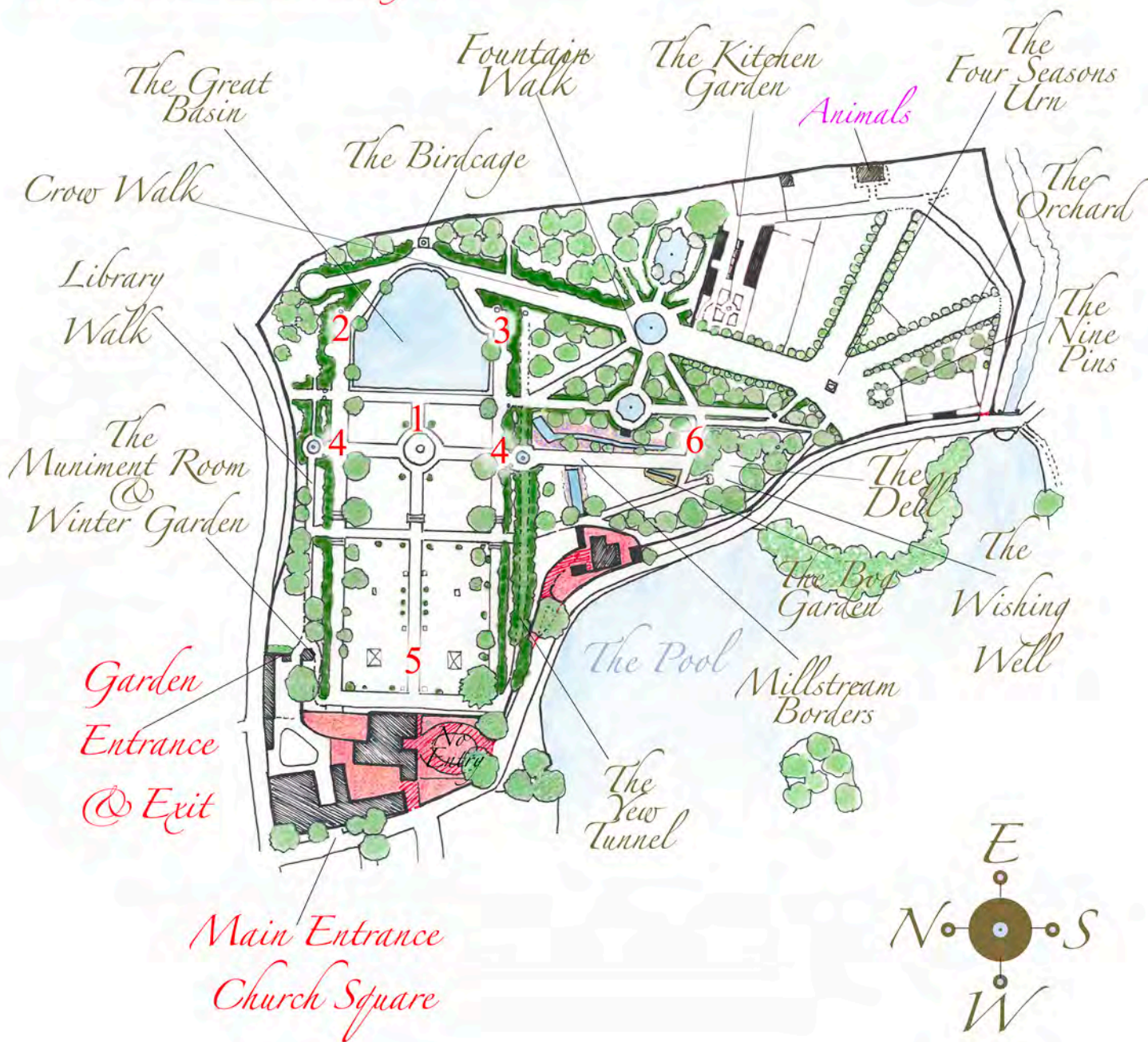

Please be sure to wear appropriate clothing & suitable footwear in the gardens.

For your safety, please be warned that there are a number of unfenced ponds in the gardens. It is not advisable to leave children & dependants unsupervised.

All visitors enter the gardens at their own risk.